

buildingSMART Data Dictionary

Håndtering av objektinformasjon

Håvard Bell, PhD

Catenda

Status - Enabling bSDD

- IFC4
 - Psets
 - The rest
- Bulk upload tool from Austria
- **4 million EURO** invested by commercial companies, in bSDD
- Products available on the market
 - IFD SignOn, coBuilder Pro, ProductXchange, bimsync, KnowledgeSearch



Data Dictionary

"En bolig må ha minst ett bad..."

baad

The screenshot shows a BIM software interface with a 3D model of a room. A red circle highlights a wall element. The right-hand panel displays the properties for this element:

Identification	
ObjectType	
InteriorOrExteriorSpace	INTERNAL
LongName	SAD
Description	
ElevationWithFlooring	0.0
CompositionType	ELEMENT
GlobalId	3M3rdVpQ7V8WthDh8ET
Part_SpaceCommon	
GlobalId	1DcPPnU4uWpnd5mndEj
ConcealedCasing	FALSE
ConcealedFlooring	FALSE
GravelPannedArea	0.0
HandicapAccessible	FALSE
NotPannedArea	0.0
PubliclyAccessible	FALSE
AC_Part_RemovalAndPhasing	
GlobalId	5S8KAmJcFUpAAuN8W2I
Removal Status	New
ePart_offset	
GlobalId	3ypcP1_HeflvoQamWW2R0a

Models

ARK Revision 1

RIS Revision 1

RSE Revision 1

RIV Revision 1

Containment

- Referansulygg Lykkabó TEK10 ARK
 - Site
 - Referansulygg Lykkabó TEK10 ARK
 - 1. etasje
 - 2. etasje
 - Kjeller
 - Tak

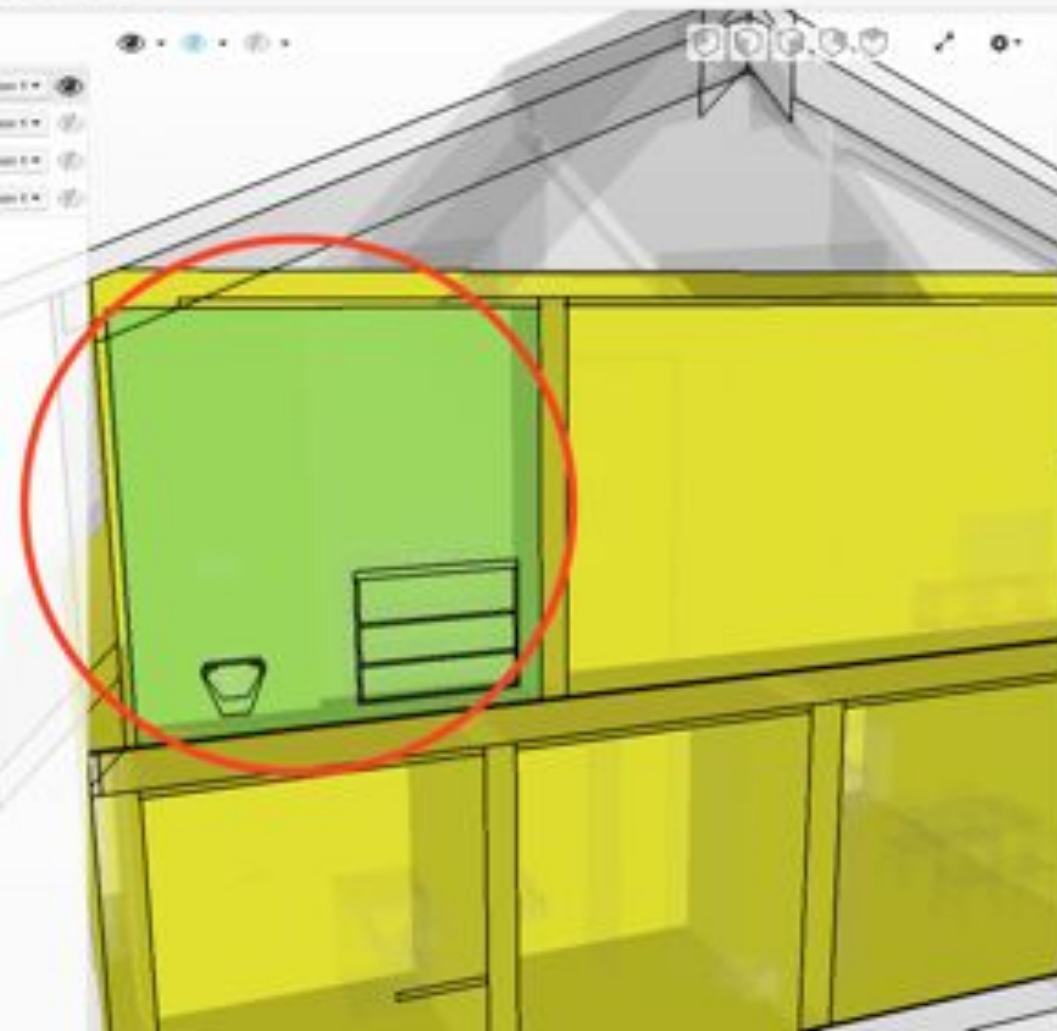

Inspect B300

Identification

InteriorOrExteriorSpace	INTERNAL
ElevationWithFlooring	0.0
LongName	BAD E.ETG
ObjectType	
GuidId	0B0QYnV0P1TQpLPO0N6M
CompositionType	ELEMENT
Description	
Views	
GuidId	0H6cTh4Ez_V3puOs0R6ec5E
PredefinedType	NOTDEFINED
Tag	28226751-9E0F-8F0F-3E0D-0B610098504E

Foot_SpaceCommon

GuidId	1_88F7EvL4BmC20Qps0AM
ConnectedCeling	FALSE
ConnectedFlooring	FALSE
GrossPlannedArea	0.0
HandicapAccessible	FALSE
NetPlannedArea	0.0
PubliclyAccessible	FALSE

The screenshot displays the BIMBA software interface. On the left, a navigation pane lists room identifiers from A3-212 to A3-999, with A3-218 highlighted in green. The central 3D view shows a floor plan with a green-shaded room. On the right, a properties panel for 'A3-218' is open, showing various attributes and values.

Identification	
A3-218	A3-218
InteriorOrExteriorSpace	INTERNAL
ElevationWithFlooring	3.0
Description	WC
LongName	WC
GlobalId	2_ucGqK050HhU3JMitg_Blc
CompositionType	ELEMENT
Post_SpaceThermalDesign	
GlobalId	3vu_UUHV0EgnqK50hwapn
Description	A3-218
VentilationAirFlowrate	0.0
ExhaustAirFlowrate	0.0
TotalHeatLoss	0.0
CoolingDesignAirflow	0.0

hovedbad

baderom

spabad

luksusbad

gjestebad

"Et våtrom skal ha sluk..."

er "hovedbad"
et våtrom?

www.buildingsmart.tech.org/10/PC2/PropIndex.htm

Industry Foundation Classes Release 4 (IFC4)

E | buildingsSMART International Ltd 1996-2013

1. Cover page	2. Contents	3. Foreword	4. Introduction	5. Scope	6. Normative references	7. Terms, definitions and abbreviated terms	8. Fundamental concepts and assumptions	9. Core schemas	10. Shared schemas	11. Domain schemas	12. Resource schemas	13. Computer-interpretable settings	14. Algorithmic settings	15. Interface settings	16. Diagrams	17. Examples	18. Change log	19. Buildings4life	20. Index
---------------	-------------	-------------	-----------------	----------	-------------------------	---	---	-----------------	--------------------	--------------------	----------------------	-------------------------------------	--------------------------	------------------------	--------------	--------------	----------------	--------------------	-----------

2.3.4.9 Part_BulkerTypeCommon

PRET_TYPRESERVEOVERLOAD / Bulker

Bulker type common attributes. SoundLevel attribute defined in IFC422 Part Additional: Use SoundProperties instead. PrimaryEnergySource and AuxiliaryEnergySource attributes defined in IFC422 Part Additional: Use EnergyProperties, FuelProperties, etc. instead.

此文件定义了公共属性。SoundLevel 属性在 IFC422 部分附加中定义：请使用 SoundProperties 代替。PrimaryEnergySource 和 AuxiliaryEnergySource 属性在 IFC422 部分附加中定义：请使用 EnergyProperties, FuelProperties 等代替。

buildingsSMART data Extension

IFC 422

- Reference**
 - Reference** Reference ID for this specified code in this project (e.g. type "X-1"), provided, if there is no classification reference to a recognized classification system used.
 - 参照ID：在此项目中为该指定代码（例如，类型“X-1”）提供的，如果不存在指向已识别分类系统中使用的任何已知分类系统的分类引用。
 - Référence** Identification de référence pour ce type spécifique à ce projet, c'est-à-dire type "X-1", fourni à partir du moment où, s'il n'y a pas de référence de classification par rapport à un système de classification reconnu et en usage.
- Status**
 - STATUS** (NEW, EXISTING, DEMOLISH, TEMPORARY, OTHER, NOTKNOWN, UNSET)
 - Status** Status of the element, preliminarily used in renovation or retrofitting projects. The status can be assigned to be "New" - element designed as new addition, "Existing" - element exists and remains, "Demolish" - element existed but is to be demolished, "Temporary" - element will exist only temporarily (like a temporary support structure).
 - 状态：新、现有、拆除、临时、其他、未知、未设置。
 - Statut** État de l'élément, utilisé avant tout pour les projets de rénovation et réaménagement. L'état assigné peut être "Nouvel" - l'élément prévu pour du neuf, "Existant" - l'élément existait et est maintenu, "Démolir" - l'élément existait mais doit être démolir/supprimé, "Provisoire" - l'élément existait à titre provisoire seulement (comme un support structurel par exemple).
- PressureRating**
 - PressureRating** Nominal pressure rating of the boiler as rated by the agency having jurisdiction.
 - 额定压力：经核准机构认证的额定压力。
 - PressionAdmissibleNominale** Pression nominale admissible de la chaudière comme classé par l'organisme qui lui est autorisé.
- OperatingMode**
 - OperatingMode** Identifies the operating mode of the boiler.
 - 运行方式：运行模式（例如，连续、间歇、...）
 - ModeFonctionnement** Identifie le mode de fonctionnement de la chaudière.
- HeatTransferSurfaceArea**
 - HeatTransferSurfaceArea** Total heat transfer area of the vessel.
 - 换热面积：换热面的总面积。
 - SurfaceEchangeChaleur** Surface totale d'échange de chaleur du foyer.
- NominalPartLoadRatio**
 - NominalPartLoadRatio** Allowable part-load ratio range.
 - 部分负荷范围：允许的负荷范围。
 - PlageNominaleChargePartielle** Plage de charge partielle admissible.
- WaterInletTemperatureRange**
 - WaterInletTemperatureRange** Allowable water inlet temperature range.
 - 入口水温范围：入口水温范围。
 - PlageTempératureAlimentationEnEau** Plage de température de l'alimentation en eau admissible.

buildingSMART Data Dictionary

Official IFC Property Set



Pset_BoilerTypeCommon

from buildingSMART Data Dictionary

Name	Value
	<ul style="list-style-type: none"> • Status • HeatTransferSurfaceArea • OutletTemperatureRange • EnergySource • WaterStorageCapacity • OperatingHours
Properties	<ul style="list-style-type: none"> • NominalEnergyConsumption • WaterInletTemperatureRange • NominalPartLoadRatio • PressureRating • WaterStorageWater • PartLoadEfficiencyCurve • References
ifcName	Pset_BoilerTypeCommon
ifcVersion	2x4
ifcDefinition	<p>Boiler type common attributes. SoundLevel attribute deleted in IFC2x4 Part Attachment Use</p> <p>ifcSoundProperties instead. PrimaryEnergySource and AuxiliaryEnergySource attributes deleted in IFC2x4 Part Attachment Use. ifcEnergyProperties, ifcFuelProperties, etc. instead.</p>
Applicability	undefined
ApplicableClasses	ifcBoiler
ApplicableTypes	undefined
Guid	7f1c4d9584e000000000000000000000

• Official IFC format

Property Set Name	Part_BulidTypeCommon
Applicable Entities	
Applicable Type Value	
Definition	Bulid type common attributes. SoundLevel attribute defined in BPC2D Part_Architecture. Use BcSoundProperties (sound). PrimaryEnergySource and AuxiliaryEnergySource attributes defined in BPC2D Part_Architecture. Use BcEnergyProperties, BcFuelProperties, etc. instead.

Property Definitions

Name	Property Type	Data Type	Definition
<ul style="list-style-type: none"> Part.FireType Part.Fire 	BcPropertySetEnumValue	FireType_Enum	<p>Means of fire detection, automatically used in detection or monitoring projects. The status can be assigned to a "New" - element designed as new addition, "Existing" - element status and variants, "Demolish" - element marked for demolition.</p> <p>"Temperature" - element will create only temperature (EIR) or temperature range (element).</p> <ul style="list-style-type: none"> Part.FireType (EIR) = 0: NEW, 1: EXISTING, 2: DEMOLISH, 3: TEMPORARY, 4: COLLAPSE, 5: NOTKNOWN, 6: UNSPECIFIED Part.FireType (Temperature) = 0: NEW, 1: EXISTING, 2: DEMOLISH, 3: TEMPORARY, 4: COLLAPSE, 5: NOTKNOWN, 6: UNSPECIFIED Part.FireType (Temperature Range) = 0: NEW, 1: EXISTING, 2: DEMOLISH, 3: TEMPORARY, 4: COLLAPSE, 5: NOTKNOWN, 6: UNSPECIFIED
<ul style="list-style-type: none"> Part.FireTransferArea Part.FireTransferArea 	BcPropertySetFloatValue	BcFloatMeasure	<p>Total heat transfer area of the total.</p> <ul style="list-style-type: none"> Part.FireTransferArea = 0: NEW, 1: EXISTING, 2: DEMOLISH, 3: TEMPORARY, 4: COLLAPSE, 5: NOTKNOWN, 6: UNSPECIFIED
<ul style="list-style-type: none"> Part.FireTemperatureRange Part.FireTemperatureRange 	BcPropertySetFloatValue	BcThermalZoneTemperatureMeasure	<p>Allowable indoor temperature of either the water or the steam.</p> <ul style="list-style-type: none"> Part.FireTemperatureRange = 0: NEW, 1: EXISTING, 2: DEMOLISH, 3: TEMPORARY, 4: COLLAPSE, 5: NOTKNOWN, 6: UNSPECIFIED
<ul style="list-style-type: none"> Part.FireEnergySource Part.FireEnergySource 	BcPropertySetEnumValue	FireType_EnergySource	<p>Enumeration defining the energy source or fuel contained in generator heat.</p> <ul style="list-style-type: none"> Part.FireEnergySource (EIR) = 0: FUEL, 1: COAL, 2: OIL, 3: GAS, 4: WOOD, 5: WOOD_PELLET, 6: WOOD_PEA-VEGARD, 7: OTHER, 8: NOTKNOWN, 9: UNSPECIFIED Part.FireEnergySource (Temperature) = 0: FUEL, 1: COAL, 2: OIL, 3: GAS, 4: WOOD, 5: WOOD_PELLET, 6: WOOD_PEA-VEGARD, 7: OTHER, 8: NOTKNOWN, 9: UNSPECIFIED
<ul style="list-style-type: none"> Part.FireStorageCapacity Part.FireStorageCapacity 	BcPropertySetFloatValue	BcFloatMeasure	<p>Water storage capacity.</p> <ul style="list-style-type: none"> Part.FireStorageCapacity = 0: NEW, 1: EXISTING, 2: DEMOLISH, 3: TEMPORARY, 4: COLLAPSE, 5: NOTKNOWN, 6: UNSPECIFIED
<ul style="list-style-type: none"> Part.FireOperatingMode Part.FireOperatingMode 	BcPropertySetEnumValue	FireType_OperatingMode	<p>Identifies the operating mode of the boiler.</p> <ul style="list-style-type: none"> Part.FireOperatingMode (EIR) = 0: FUEL, 1: COAL, 2: OIL, 3: GAS, 4: WOOD, 5: WOOD_PELLET, 6: WOOD_PEA-VEGARD, 7: OTHER, 8: NOTKNOWN, 9: UNSPECIFIED Part.FireOperatingMode (Temperature) = 0: FUEL, 1: COAL, 2: OIL, 3: GAS, 4: WOOD, 5: WOOD_PELLET, 6: WOOD_PEA-VEGARD, 7: OTHER, 8: NOTKNOWN, 9: UNSPECIFIED
<ul style="list-style-type: none"> Part.FirePowerConsumption Part.FirePowerConsumption 	BcPropertySetFloatValue	BcFloatMeasure	<p>Annual fuel consumption (per required) to produce the total boiler heat output.</p> <ul style="list-style-type: none"> Part.FirePowerConsumption = 0: NEW, 1: EXISTING, 2: DEMOLISH, 3: TEMPORARY, 4: COLLAPSE, 5: NOTKNOWN, 6: UNSPECIFIED
<ul style="list-style-type: none"> Part.FireTemperatureRange Part.FireTemperatureRange 	BcPropertySetFloatValue	BcThermalZoneTemperatureMeasure	<p>Allowable water side temperature range.</p> <ul style="list-style-type: none"> Part.FireTemperatureRange = 0: NEW, 1: EXISTING, 2: DEMOLISH, 3: TEMPORARY, 4: COLLAPSE, 5: NOTKNOWN, 6: UNSPECIFIED
<ul style="list-style-type: none"> Part.FireTotalCapacity Part.FireTotalCapacity 	BcPropertySetFloatValue	BcFloatMeasure	<p>Allowable total boiler output.</p> <ul style="list-style-type: none"> Part.FireTotalCapacity = 0: NEW, 1: EXISTING, 2: DEMOLISH, 3: TEMPORARY, 4: COLLAPSE, 5: NOTKNOWN, 6: UNSPECIFIED

buildingSMART Data Dictionary

Search Browse About

Sign in Sign up

Type a name of a property that the search you are going to use to search the Dictionary. To restrict the results, use an asterisk (*) after the name:

Pool_BoilerTypeCommon

- Boiler type common
- Pool

nest

1
2012-07-19 16:08:35

Boiler type common
Pool_BoilerTypeCommon

この項目は標準的なボイラタイプ、SoundLevel属性はFCOD pool属性で指定する必要があります。RtSoundProperties属性はFCOD pool属性で指定する必要があります。また、FCOD pool属性で指定する必要があります。RtEnergyProperties、RtFuelProperties属性はFCOD pool属性で指定する必要があります。

Boiler type common attributes. SoundLevel attribute defined in FCOD Pool Attribute. Use RtSoundProperties instead. PrimaryEnergySource and AuxiliaryEnergySource attributes defined in FCOD Pool Attribute. Use RtEnergyProperties, RtFuelProperties, etc. instead.

is collection for

- Boiler (Contains: 411-444)

is part of collection

- All properties from An (Contains: Resource Term)
- Term (Contains: 411-444)

has properties with values

- Boiler type common: nominal part load ratio, nominal part load ratio (Contains: 411-444)
- Boiler type common: status, status (Contains: 411-444)
- Boiler type common: operating mode, Operating mode (Contains: 411-444)
- Boiler type common: outlet temperature range, outlet temperature range (Contains: 411-444)
- Boiler type common: energy source, energy source (Contains: 411-444)
- Boiler type common: water inlet temperature range, water inlet temperature range (Contains: 411-444)

has members

- Boiler type common: status, status (Contains: 411-444)

buildingSMART Data Dictionary

Search Browse About

Sign in

Topic name of a resource that the search you are going to use to search the Dictionary. To restrict the results, use an asterisk (*) after the term.

ThermalTransmittance

- slab common, thermal transmittance, Thermal transmittance
- beam common, thermal transmittance, Thermal transmittance
- plate common, thermal transmittance, Thermal transmittance
- door common, thermal transmittance, Thermal transmittance
- building element group common, thermal transmittance, Thermal transmittance
- covering common, thermal transmittance, Thermal transmittance
- stairway common, thermal transmittance, Thermal transmittance
- member common, thermal transmittance, Thermal transmittance
- shading device common, thermal transmittance, Thermal transmittance
- slipout common, thermal transmittance, Thermal transmittance
- curtain wall common, thermal transmittance, Thermal transmittance
- wall common, thermal transmittance, Thermal transmittance
- window common, thermal transmittance, Thermal transmittance
- wall common, thermal transmittance, Thermal transmittance

property

URI: <http://uri.ispartof.org/000005423/>

1

2013-07-20 04:31:56

wall common, thermal transmittance, Thermal transmittance

Part, WallCommon, ThermalTransmittance, ThermalTransmittance

U-Wert

TransmissionThermique

熱貫流率

熱貫流率

Wärmedurchgangskoeffizient (U-Wert) der Massenelemente. Hier der Gesamtwärmedurchgangskoeffizient der Wand (U) als Schichten.

View More

has measure

Thermal transmittance measure (Common: PT-104)

is a type of

- property single value (Common: PT-104)

is part of collection

- wall common (Common: PT-104)

buildingSMART Data Dictionary

Search:

Tools: Browse | About | 4 contents selected

Type a name of a concept into the search box and press enter to search the Dictionary. To expand the search, use the controls to the left.

Search concept

- 🔍 wall
- 🔍 WALL
- 🔍 IT
- 🔍 WALL
- 🔍 wall
- 🔍 wall

subject

- 🇺🇸 wall
- 🇩🇪 Wall
- 🇩🇪 mauer
- 🇩🇪 Wand
- 🇩🇪 mauer
- 🇩🇪 mauer
- 🇩🇪 mauer
- 🇩🇪 mauer

[BuildingSMART Data Dictionary](#)

1

2012.07.17 09:44:38

[Add comments...](#)

has properties

position, location, point

File IFC-Data LOD 300-US LOD 350-US

assembly type

File IFC-Data LOD 300-US LOD 350-US

has subtypes

- 🔍 similar frame wall panel
 - File IFC-Data LOD 300-US LOD 350-US
- 🔍 concrete wall
 - File IFC-Data LOD 300-US LOD 350-US
- 🔍 similar framework wall
 - File IFC-Data LOD 300-US LOD 350-US
- 🔍 similar wall
 - File IFC-Data LOD 300-US LOD 350-US

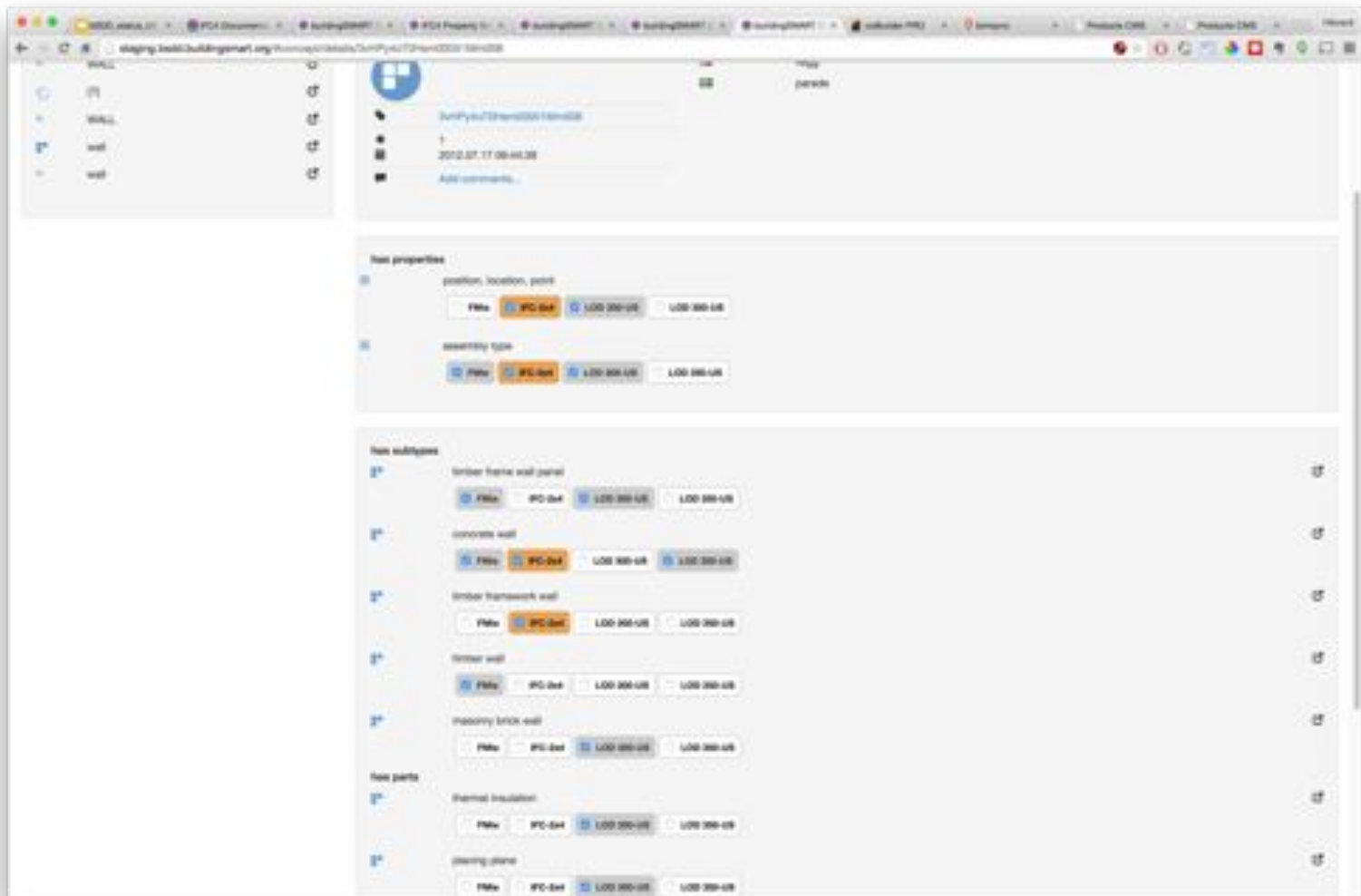

IFD SignOn

IFD SignOn - Purchasing

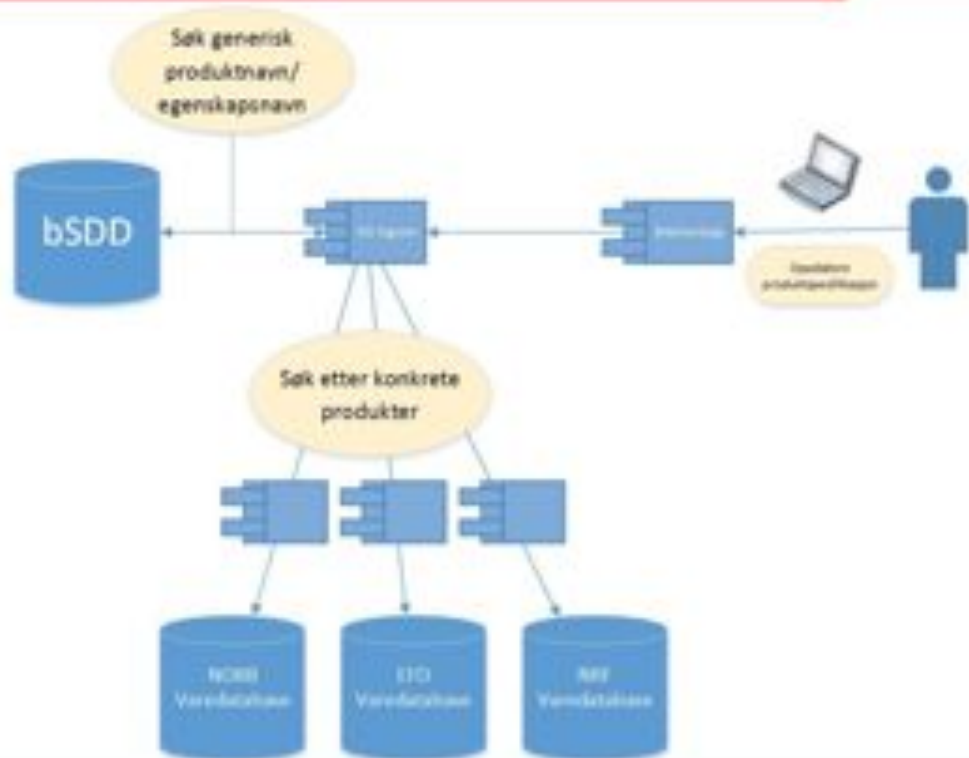

Product
Search
Get

Varegrupper

04 - Emballasje

13 - Dører

1310 - Innerdører

1310100 - Fyllingsdører

1310200 - Profilerte/sporfeste dører

1310400 - Formpressede dører

27378322 - INNERDØR STIL 374 SPEIL HVIT

27378371 - INNERDØR STIL 378 SPEIL HVIT

27378389 - INNERDØR STIL 379 GLASS HVIT

27380666 - INNERDØR STIL 375 GLASS HVIT

27380674 - INNERDØR STIL 9374 MASSIV UKL HVIT

28693208 - INNERDØR STIL 383 GLASS HVIT

41859997 - INNERDØR STIL 396 TETT HVIT

41860001 - INNERDØR STIL 394 SPEIL HVIT

41860016 - INNERDØR STIL 398 SPEIL HVIT

41862956 - INNERDØR STIL 9378 MASSIV UKL HVIT

41892106 - INNERDØR PAR STIL 375 HVIT

41892114 - INNERDØR PAR STIL 379 HVIT

41892125 - INNERDØR PAR STIL 383 HVIT

Stikkord Standarder Tilhørende varer Godkjenning Media Egenskaper

Legg til/endre verdier ved å dobbeltklikke i cellen, eller marker og tast F2

Egenskap	Verdi	Enhet		Ikke relevant
brannklasse				<input type="checkbox"/>
lengde		centimeter		<input type="checkbox"/>
CE-merke	Ja			<input type="checkbox"/>
EPO	Nei			<input type="checkbox"/>
Glasstype	Dekorglass			<input type="checkbox"/>
Godkjent for handikappet	Ja			<input type="checkbox"/>
Hengsling	Høyre			<input type="checkbox"/>
Inndruidukkerhet				<input checked="" type="checkbox"/>
Innhold av miljøgifter iht sjekkliste A20	Nei			<input type="checkbox"/>
lengde		centimeter		<input type="checkbox"/>
Ligger produktet i Eco-product				<input type="checkbox"/>
PEFC-sertifisert	Nei			<input type="checkbox"/>
Produktbeskrivelse	Ja			<input type="checkbox"/>
Produktsett/fikat	Ja			<input type="checkbox"/>

Statistikkoversikt 97%

Opprettes dato 07.06.2009

Sist endret dato 03.11.2011

Opplyt dato

Erstatnings nr

OK

OK

Search for genuine Products

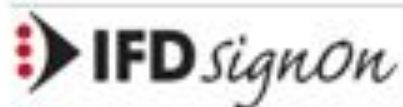

Varespesifikasjoner

Generisk produkt

Egenskaper

Varer

Verifiser varespesifikasjon 'Teknisk Bygg (ALLE OBJEKTER allefag.xls)'

[Varespesifikasjoner](#) > Verifiser

Enter product name

Door

Door

Antall	Height	Length
1	2300	900
1	2700	1200

Obliggende egenskaper:

Fast generisk produkt

Navn	Id	Vare database	Mer informasjon	FDV
DØRBL COMPACT 03 9020 HVT	27546449	NOBB	Mer informasjon	
DØRBL TRADITION 02B 9X19 ANT LARK	27544766	NOBB	Mer informasjon	
DØR 10Q21 PERHEL ANTBEIS ESPR 2X4	28906733	NOBB	Mer informasjon	
DØR 8X20 SV SPR FURU LARK LAV BR	22771117	NOBB	Mer informasjon	
DØR 8X18 T 3 EIK LARK SCAN	25975913	NOBB	Mer informasjon	
DØR 9020 PERHEL MALT HV 2X3	29146909	NOBB	Mer informasjon	
DØRBL EASY SP12 7X20 BØK FIBERT	25507112	NOBB	Mer informasjon	
DØRBL MILANO 402 8X20 EIK LARK	28691624	NOBB	Mer informasjon	

Free BIM

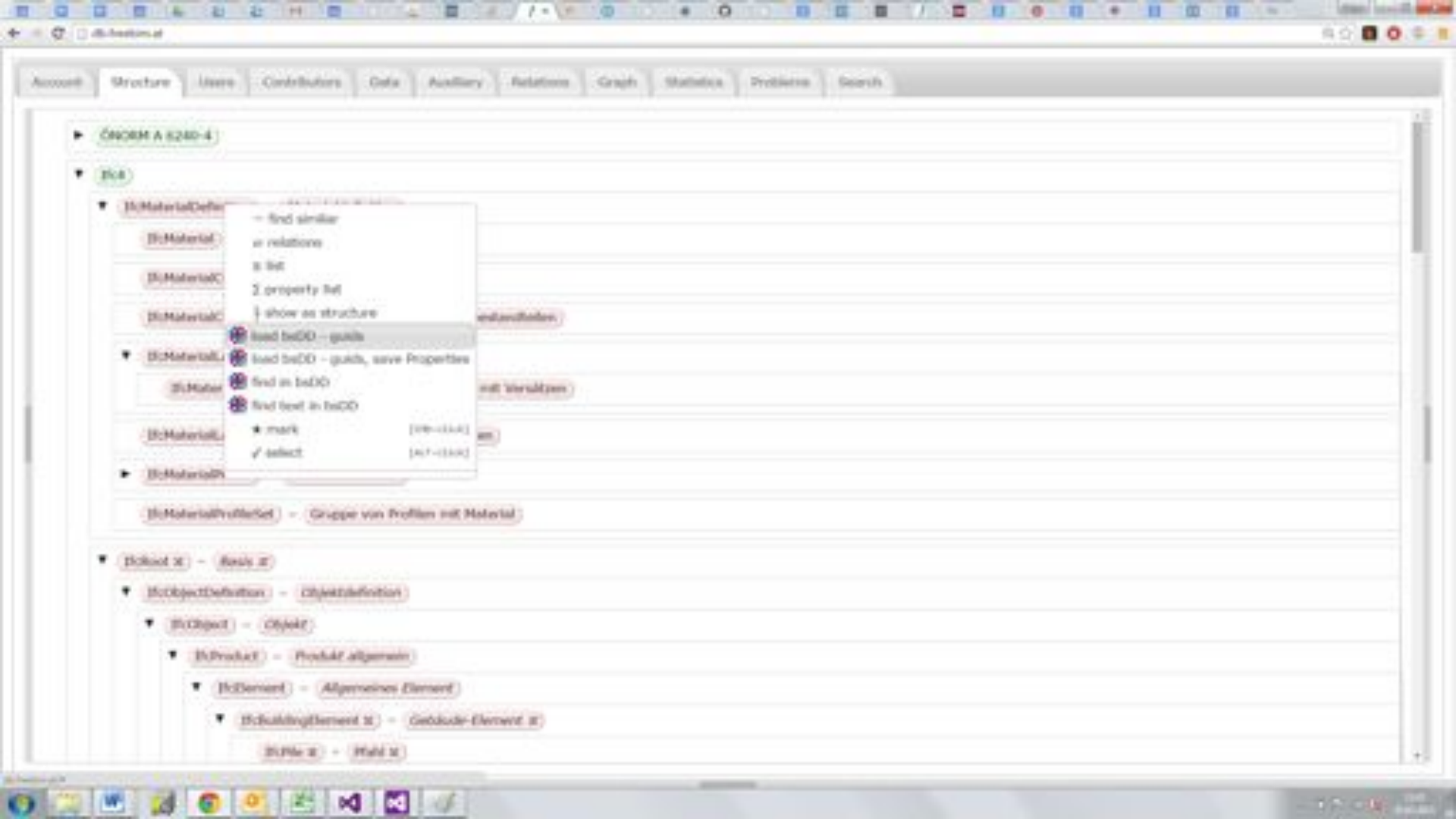



edit Property 'Höhe Mauerstein'

ISO guid:

Calc

Name

Höhe Mauerstein

Name [en]

Height masonry construction

Description

vertikale Abmessung des Mauersteins

Description [en]

vertical dimension of the masonry unit

default

Discipline

AR - Architektur



Measures

] Reelle Zahl [mm]

- + Höhe Abhangdecke Bandgegenseits height of suspended ceiling on handle side
- + Höhe Abhangdecke Bandsseite height of suspended ceiling on hinge side
- Höhe Türblatt außen Door leaf height

PROPERTY

GUID: {submitt följge}_leafheight

Version: 1 Date: 2015.02.25 13:37:53

Status: DRAFT

Language

Description

- Höhe Türblatt außen
- Door leaf height

Language

Definition

- Angabe zum Türblattaußenmaß in der Höhe
- Specification of the external dimension of the door leaf height

assigned to (parent) ... assigned elements (childs) ...

Account Structure Users Contributors Data Auxiliary Relations Graph Statistics Problems Search

Property-sets Components Properties Measures Value lists Values

Filter: exactly marked Library: freeBDH all (X₁) inverse 60

Code	Name	Status	Since
3	Aufbau (X ₁)	checked	2013-03-12 14:13:00
3	Aufbau (X ₁)	checked	2013-03-12 14:13:00
BG	Belag (X ₁)	checked	2014-08-12 19:27:37
BG	Belag (X ₁)	checked	2014-08-12 19:27:37
	Belegung (X ₂)	undefined	2014-02-21 14:28:13
	Belegung (X ₂)	undefined	2014-02-21 14:28:13
RBOB	Bodenbelag II	undefined	2013-11-14 12:49:31
RBOB	Bodenbelag II	undefined	2013-11-14 12:49:31
	Brandabschnitt (X ₂)	undefined	2014-02-21 14:10:54
	Brandabschnitt (X ₂)	undefined	2014-02-21 14:10:54
	Brandabschnitt ... ende	checked	2014-09-17 12:13:14
	Brandabschnitt ... ende	checked	2014-09-17 12:13:14
DF	Dachfläche (X ₁)	checked	2014-09-24 16:23:05
DF	Dachfläche (X ₁)	checked	2014-09-24 16:23:05
	Durchmesser (X ₁)	undefined	2014-09-22 16:21:55
	Durchmesser (X ₁)	undefined	2014-09-22 16:21:55
	Fensterbank innen (X ₁)	undefined	2013-03-26 15:56:33
	Fensterbank innen (X ₁)	undefined	2013-03-26 15:56:33
	Feuerwehraufzug (X ₁)	undefined	2014-09-11 13:26:59
	Feuerwehraufzug (X ₁)	undefined	2014-09-11 13:26:59
PW	Rauchweg (X ₁)	checked	2014-08-11 12:43:41

edit Property 'Brandabschnittsdefinierendes Bauteil'

ISO guid:

Code:

Name:

Name [en]:

Description:

Description [en]:

default:

Discipline:

Measures:

assigned to:

Cancel Delete Save



Account Structure Users Contributors Data Auxiliary Relations Graph Statistics Problems Search

▼ 00 **Objektdefinition** = IfcObjectDefinition

▼ Obj **Objekt** = IfcObject

▼ Prod **Produkt allgemein** + = IfcProduct

▼ 01 **Allgemeines Element** + = IfcElement

▼ ABS_011 **Gebäude-Element x** + = IfcBuildingElement x

► IfcCovering **Bekleidungs-element x** + = IfcCovering x

▼ 01 **Dach x** + = IfcRoof x = **Dach x**

DA-GA **Dachgauben** -

Nr. x	Code	Name	Description	Property type	Status
0		Gaubenart (Phase 01.04) +	Form der Gaube	Type	undefined
1		Gauben Breite (Phase 01.04) +		Type	undefined
2		Gauben Höhe (Phase 01.04) +		Type	undefined

► DC **Decke x** + = **Decke x** = IfcSlab x

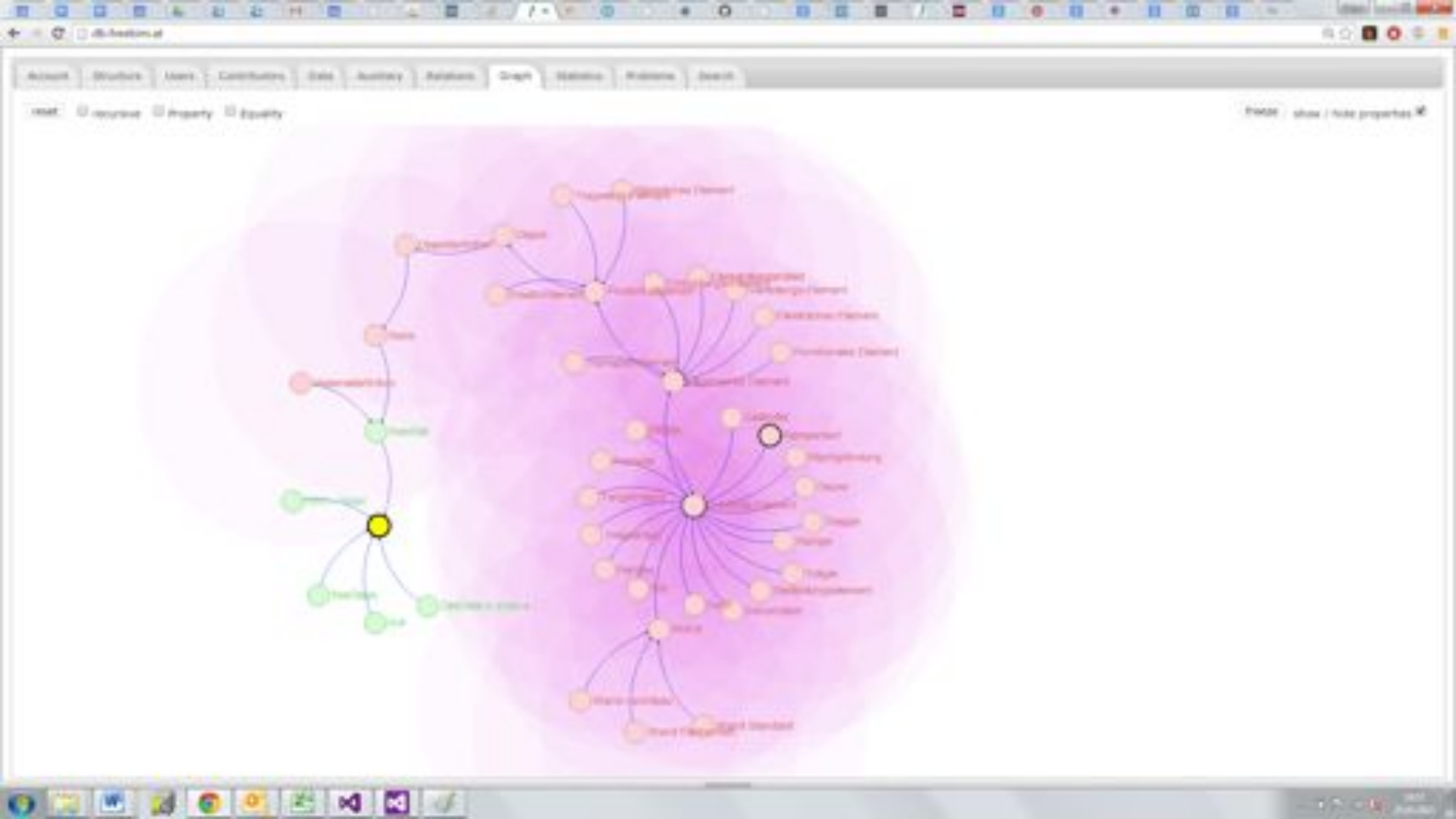

coBuilder Pro

bimsync

coBuilder PRO **WILKINSON** | Siste melding: test (000000000000)

Om coBuilderPRO | Hjelp | Om oss | Kontakt oss

Dashboard | Dokumenter | Produkter | **Produkt**

Søk i dokumenter (Inntil 3 tegn)

Gjeldende brukersted

Siste melding: test(000000000000)

Produkt | Legg til Produkt | Legg til Produkt fra favoritter

Søk i Produkt og Dokumenter

Antall pr side: Alle produkter:

Navn	Leverandør	Produkt status	Dokumenter	Favoritt	Vy
DISPLATE ETINDING 800000010 NORDPE	Høyse Norge AS	✔ ⚠ ✖	8	<input type="checkbox"/>	<input type="checkbox"/>
OPTIKUM SILVON GAA 3106, runde	Optimum AS	✔	3	<input type="checkbox"/>	<input type="checkbox"/>
WINDU 9H 1140 BRED V 2012 (interiors of WILKINSON)	Lysland Treindustri AS	✔ ✖	8	<input type="checkbox"/>	<input type="checkbox"/>
TREKOR TX 50 EL 4.5 X 20 P20 (interiors of WILKINSON)	WINDU SILVON NORGE AS	✖	8	<input type="checkbox"/>	<input type="checkbox"/>
WINDU 9H 1140 BRED ALL-I-12010 (interiors of WILKINSON)	Lysland Treindustri AS	✔ ✖	1	<input type="checkbox"/>	<input type="checkbox"/>

Antall treff: 1 - 3 av 5

Om coBuilderPRO | Om oss | Kontakt oss

© Copyright coBuilder PRO 2012. All Rights Reserved. • 17.11.12 11:21:42 | Development 1.0.0

bimsync | BIMsync 10

Library

Cobolider Pro

- OPPLATE STANDVE-KOIKOOROKI NOKPNS
- OPYFOWI SURON OMA DIML
- TREKOT TE BE EL 4.8 X 20 P20
- WREU SH HAO BASIC AQUIE IAKIS
- WREU SH HAO BASIC Y ENI

Identification

WulStandardCowl, 1.11 SH

GlobalId: 1ygfRrUJLQdVp7WUrhng

Tag: B0AMW0-4DE5-4486-A7-F5-7607A7C5F03a

Name

- Clipping** (Created by: Glen Wulsten, 4 months ago)
- will not BUILDING** (Created by: Jari Anders Salen, 3 yrs ago)

Cobolider Pro

BuildingSMART Data Dictionary

Air Filtringsg 200mm SP

GlobalId: 1yGffuXfCwvdvEHUEU

PredefinedType: NOTDEFINED

ElementType: Air Filtringsg 200mm SP

Owner and History

Created 4 years ago

Owned by: unknown person using ARCHICAD 19.0

ADDED by: unknown person using unknown application

Support | 6000

Settings | Support chat

thank you
Håvard Brekke Bell
Catenda
havard.bell@catenda.no